

# Tyče kruhové

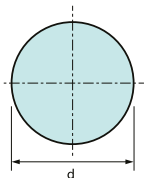

| Priemer (d) | Váha kg/m | Priemer (d) | Váha kg/m | Priemer (d) | Váha kg/m |
|-------------|-----------|-------------|-----------|-------------|-----------|
| 2,0         | 0,03      | 25,0        | 3,85      | 95,0        | 55,64     |
| 2,5         | 0,04      | 26,0        | 4,17      | 100,0       | 61,65     |
| 3,0         | 0,06      | 27,0        | 4,50      | 105,0       | 67,97     |
| 3,5         | 0,08      | 30,0        | 5,55      | 110,0       | 74,60     |
| 4,0         | 0,10      | 32,0        | 6,31      | 115,0       | 81,54     |
| 4,5         | 0,13      | 33,0        | 6,71      | 120,0       | 88,78     |
| 5,0         | 0,15      | 35,0        | 7,55      | 125,0       | 96,33     |
| 6,0         | 0,22      | 36,0        | 7,99      | 130,0       | 104,19    |
| 7,0         | 0,30      | 38,0        | 8,90      | 135,0       | 112,36    |
| 8,0         | 0,40      | 40,0        | 9,87      | 140,0       | 120,84    |
| 9,0         | 0,50      | 42,0        | 10,88     | 145,0       | 129,63    |
| 10,0        | 0,62      | 43,0        | 11,40     | 150,0       | 138,72    |
| 11,0        | 0,75      | 45,0        | 12,48     | 155,0       | 148,10    |
| 12,0        | 0,89      | 46,0        | 13,05     | 160,0       | 157,83    |
| 13,0        | 1,04      | 48,0        | 14,21     | 170,0       | 178,18    |
| 14,0        | 1,21      | 50,0        | 15,41     | 180,0       | 199,76    |
| 15,0        | 1,39      | 52,0        | 16,67     | 190,0       | 222,57    |
| 16,0        | 1,58      | 54,0        | 18,00     | 200,0       | 246,62    |
| 17,0        | 1,78      | 55,0        | 18,65     | 210,0       | 271,89    |
| 18,0        | 2,00      | 60,0        | 22,20     | 220,0       | 298,40    |
| 19,0        | 2,23      | 65,0        | 26,05     | 230,0       | 326,15    |
| 20,0        | 2,47      | 70,0        | 30,21     | 240,0       | 355,13    |
| 21,0        | 2,72      | 75,0        | 34,68     | 250,0       | 385,34    |
| 22,0        | 2,98      | 80,0        | 39,46     | 260,0       | 416,78    |
| 23,0        | 3,26      | 85,0        | 44,55     | 280,0       | 483,37    |
| 24,0        | 3,55      | 90,0        | 49,94     | 300,0       | 554,88    |